

Sheet No. 1
Sheet No. 2

DATE _____
SOURCE OF INFORMATION _____
Michigan Conservation Department
Contours at 5' intervals
SOUNDINGS _____

AREA 4,300 Acres
TOTAL SHORELINE 16.25 Miles
MAX. DEPTH 38 Feet
SCALE: 1" = 1200'

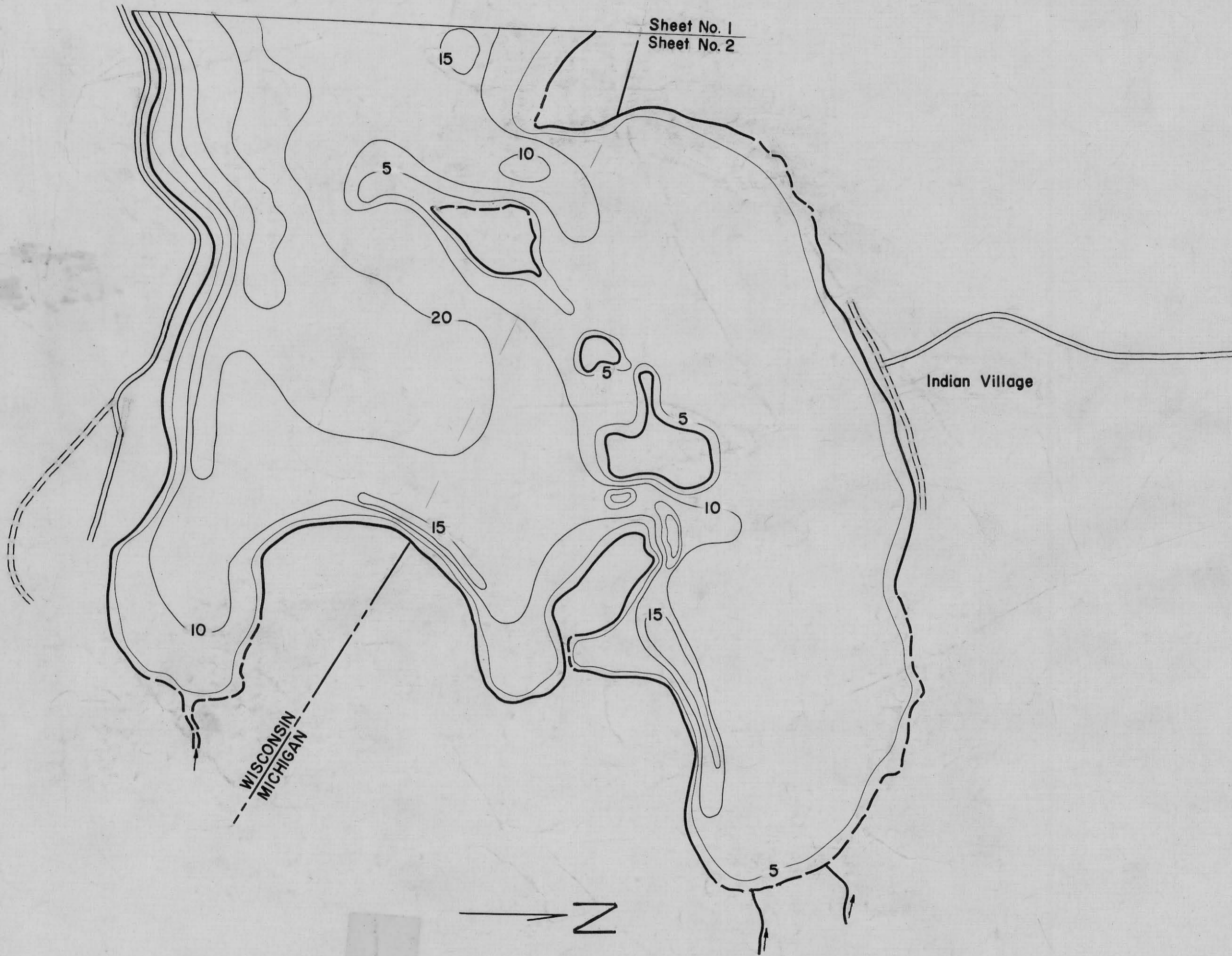

DATE _____
 SOURCE OF INFORMATION _____
 Michigan Conservation Department
 Contours at 5' intervals
 SOUNDINGS _____

AREA 4,300 Acres
 TOTAL SHORELINE 16.25 Miles
 MAX. DEPTH 38 Feet
 SCALE: 1" = 1200'

LAKE SURVEY MAP

LAKE LAC VIEUX DESERT (Sheet No. 1)

SECTION _____

TOWNSHIP T-42-N(WIS.) T-43-44-N(MICH)

RANGE R-II-E (WIS.) R-38-39-W (MICH.)

TOWN PHELPS _____

COUNTY VILAS,(WIS) GOGEBIC,(MICH)

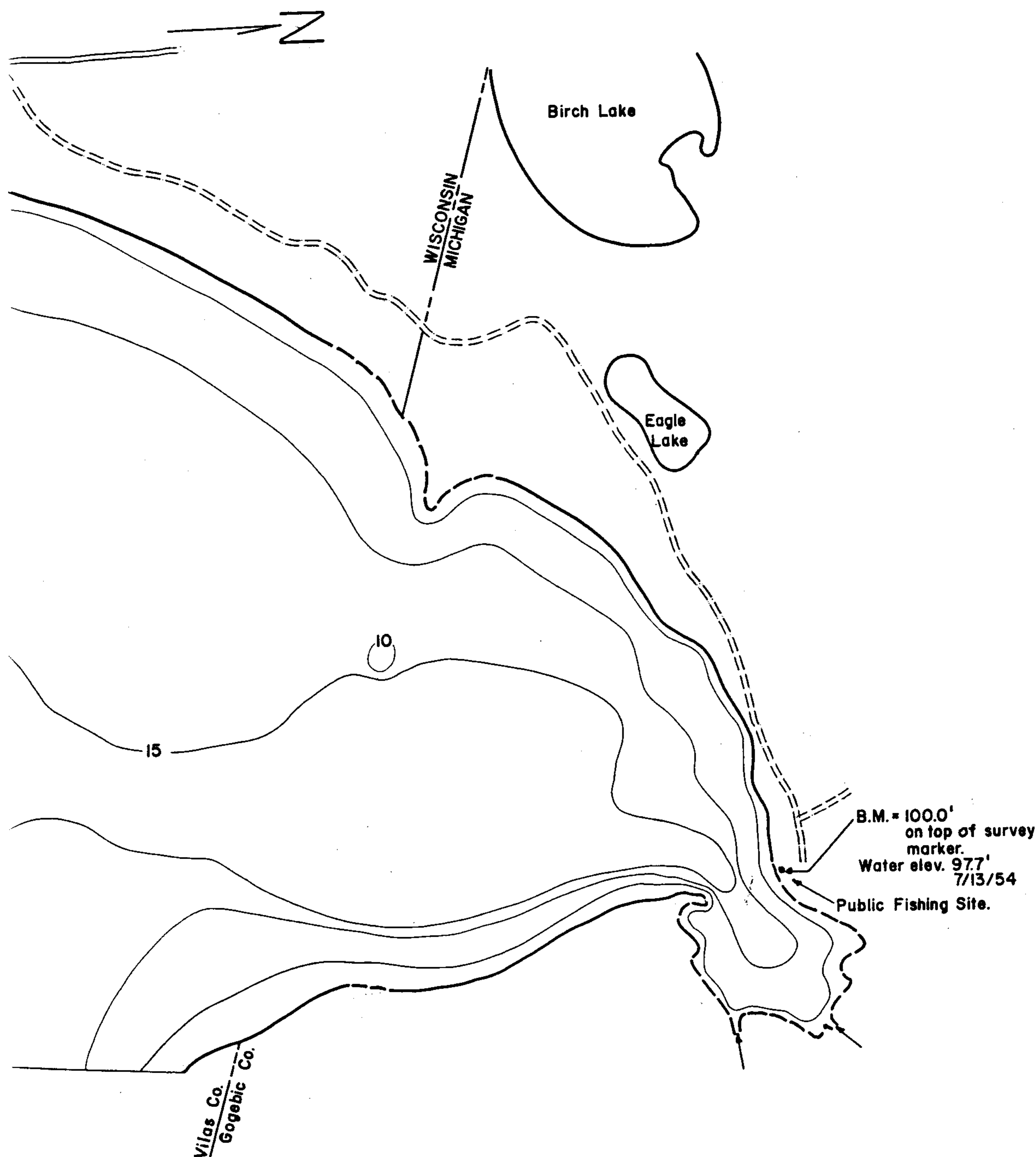

AREA 4,300 Acres

TOTAL SHORELINE 16.25 Miles

MAX. DEPTH 38 Feet

SCALE: 1" = 1200'

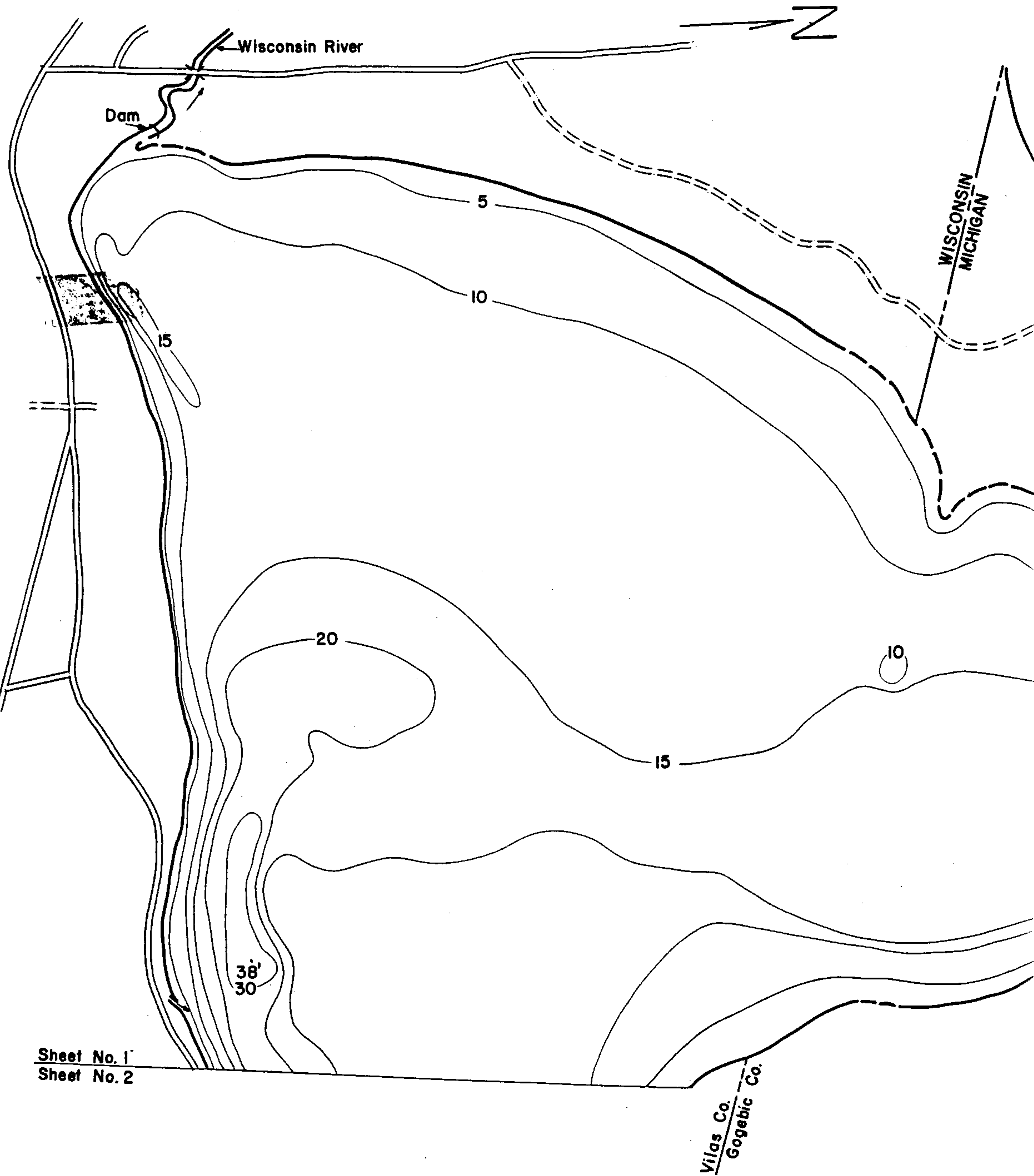

DATE _____

SOURCE OF INFORMATION _____

Michigan Conservation Department

Contours at 5' intervals

SOUNDINGS _____



AREA 4,300 Acres

TOTAL SHORELINE 16.25 Miles

MAX. DEPTH 38 Feet

SCALE: 1" = 1200'

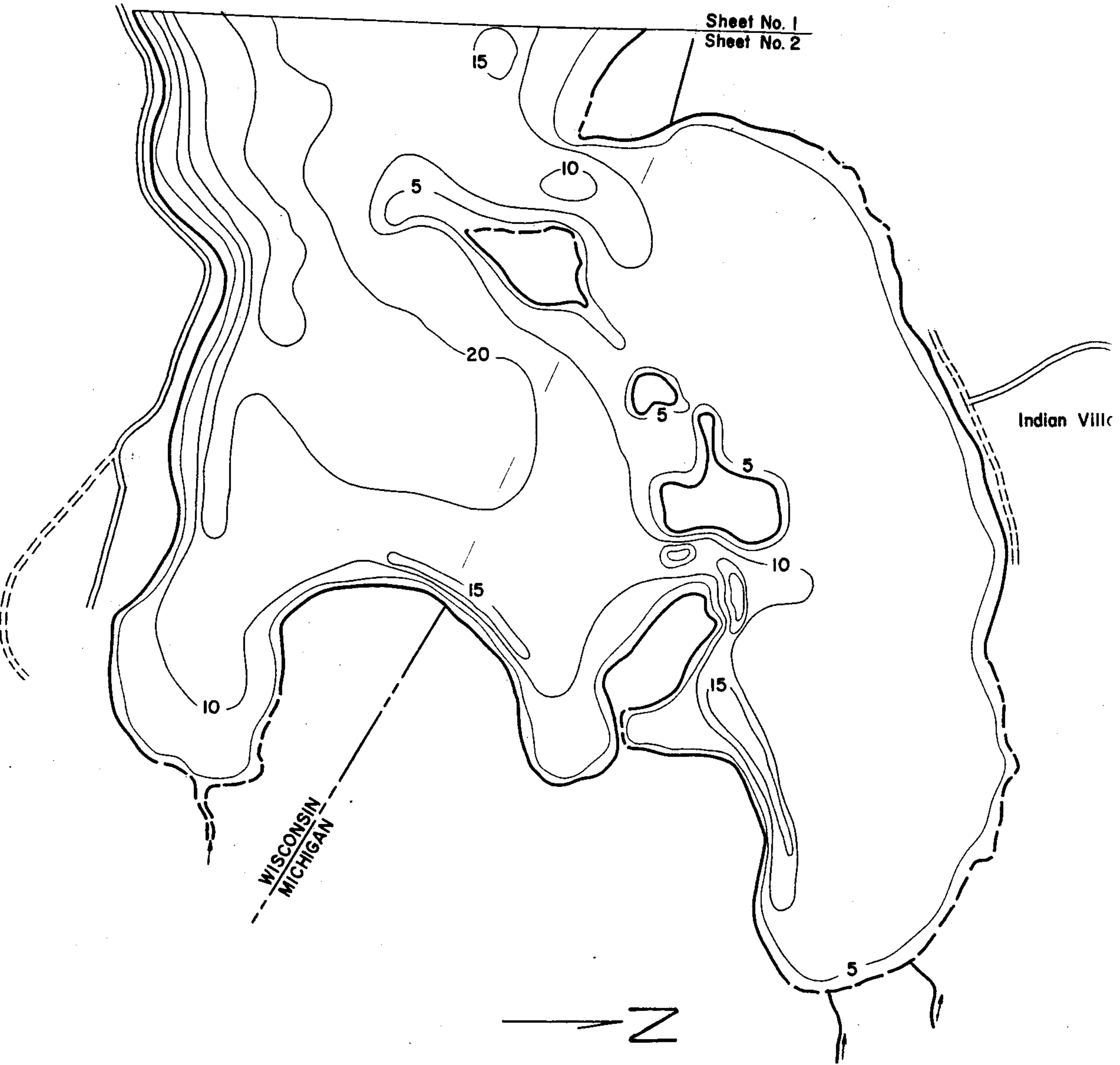

DATE _____

SOURCE OF INFORMATION _____

Michigan Conservation Department

Contours at 5' intervals

SOUNDINGS _____

Source: Wisconsin Department of Natural Resources 608-266-2621
Lac Vieux Desert Lake - Vilas County, Wisconsin DNR Lake Map
Date – Jul 1954 - Historical Lake Map - Not for Navigation
A Public Document - Please Identify the Source when using it.